



ESHRE 2025

Briefing Exhibit



Onsite Access - stand builders & stand holders

From Thursday 26 June 07:00 till Sunday 29 June before 17:00

- Stand builders can only access the exhibit hall with an **orange wristband**
-> See info about pick-up on the next page



From Saturday 28 June after 13:00 till the end of the congress

- Exhibitors wearing a **congress badge with an orange line** can access the exhibit halls during build-up, during the congress days outside opening hours, and during breakdown
-> Pick-up badges at the registration kiosks in the registration area
- Stand builders wearing an **orange wristband** can access the exhibit hall until Sunday, 29 June 17:00, and during dismantling

Exhibitor badges

The exhibitor badges will have one or two colours:

- Pink** = access to exhibit during opening hours (Mon-Tue: 08:30-17:00, Wed: 08:30-14:00)
- Orange** = access to exhibit outside opening hours congress

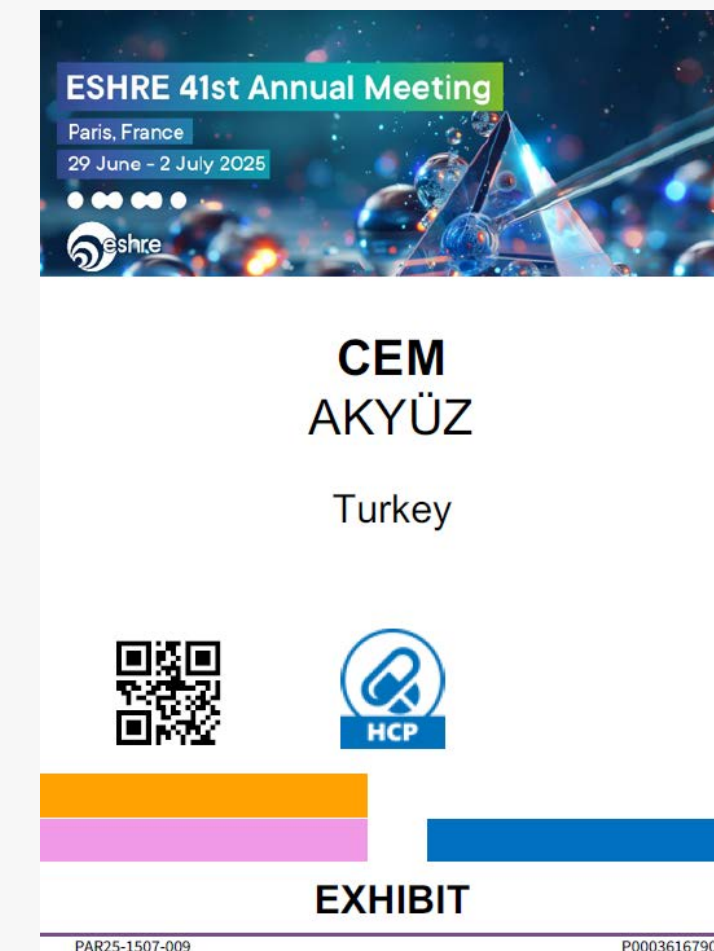

Build-up and dismantling dates and times

See <https://www.eshre.eu/ESHRE2025/Exhibit-and-Sponsors/Build-up-and-dismantling>



Pick-up locations - Orange wristbands

7.2.C: Trailers for forklift services

- Thursday, 26 June: 07:00-14:00
- Friday, 27 June: 07:00-12:00
- Saturday, 28 June: go to the Atrium

7.2.A: Self-unloaders

- Thursday, 26 June: 07:00-14:00
- Friday, 27 June: 07:00-19:00
- Saturday 28 June: 07:00-19:00
- Sunday, 29 June: 07:00-14:30

Atrium –in front of 7.2.

- Thursday, 26 June: 07:00-21:00
- Friday, 27 June: 07:00-21:00
- Saturday 28 June: 07:00-21:00
- Sunday, 29 June: 07:00-17:00

Example wristband



Pick-up list

- To get a wristband, exhibitors need to send us the name and mobile number of their stand builder's main contact and the number of workers in their team.
- There will be a distribution desk at each access point which will be manned by hostesses

Plan pick-up locations

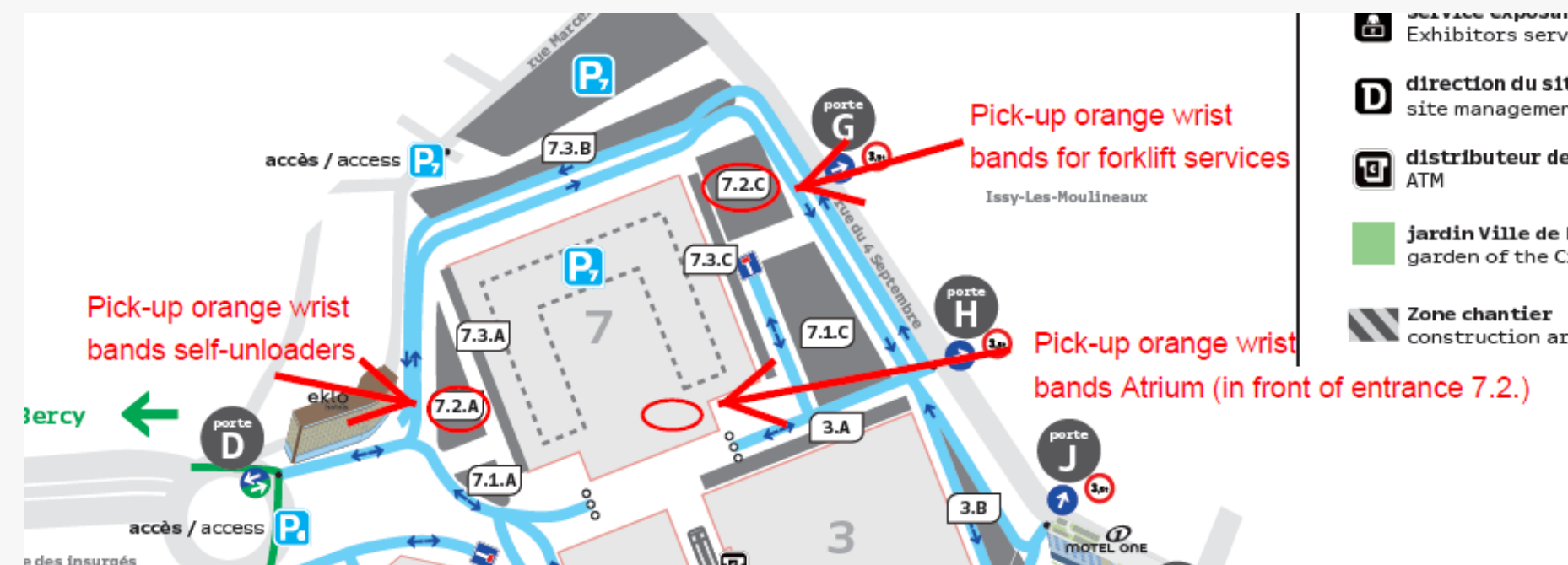

-> also see separate plan



Exhibit & Sponsorship

Exhibiting companies

212 companies will be exhibiting at ESHRE2025 (42 first-time exhibitors)

ESHRE Village & Fertility Europe in Exhibit hall

- ESHRE Village: booth #C001
- Fertility Europe (ESHRE's patient organisation): booth #B005

Exhibit hall 7.2.

The Exhibition will take place in hall 7.2. at the 1st floor, which is in the same hall as the Registration area.

Exhibit floor plan

You will be able to find the exhibit floor plan and exhibitors list on the congress website on <https://www.eshre.eu/ESHRE2025/Exhibit-and-Sponsors/Exhibit-floorplan>, in the pocket floor plan, the congress app and on the big onsite signboards.

The booth spaces are grouped into 4 blocks: A, B, C and D.

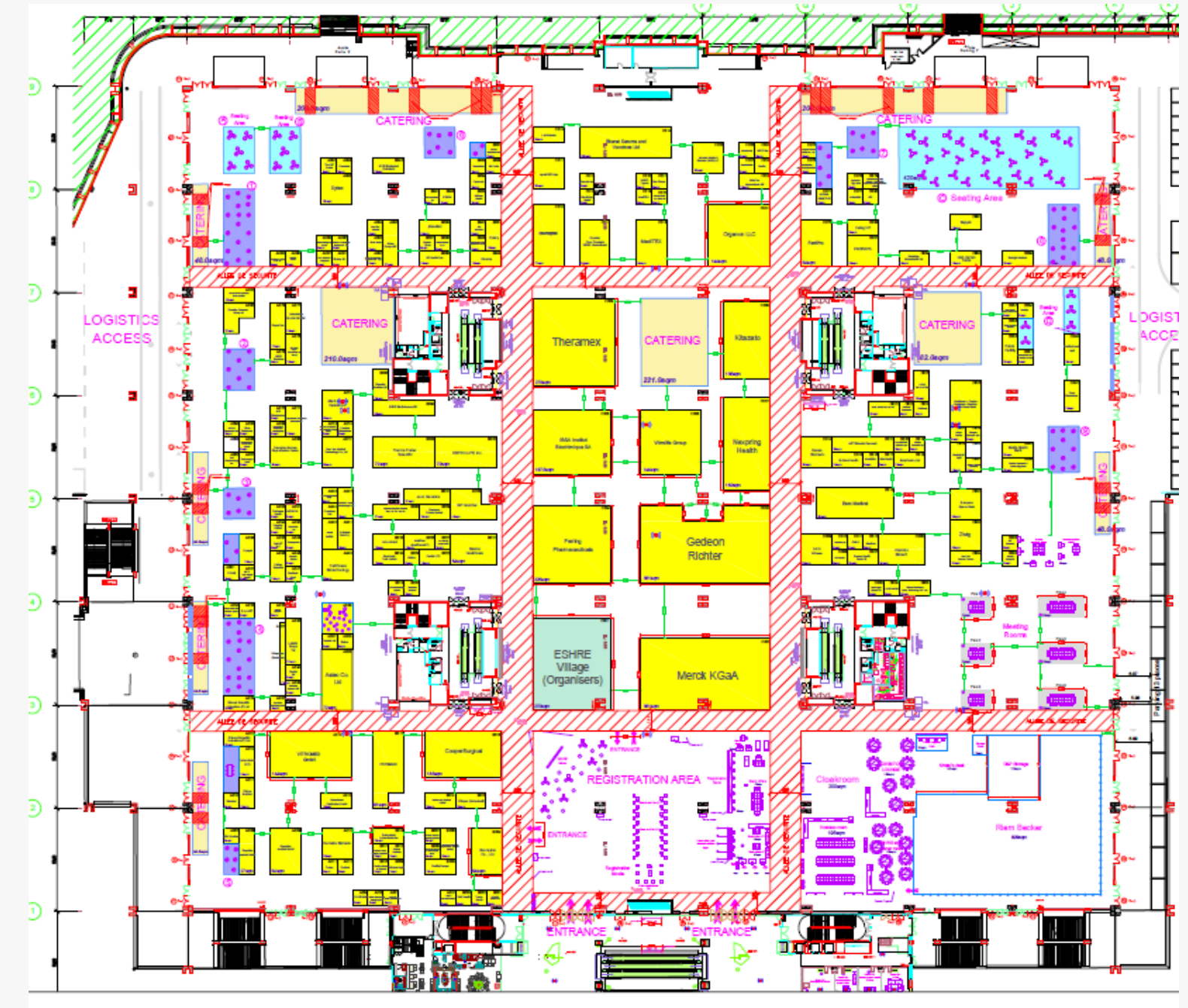



Safety shoes

Safety shoes are mandatory in the exhibit hall during build-up on:

- Thursday 26/06
- Friday 27/06
- Saturday 28/06

As of Sunday 29/06 it's not necessary anymore to wear safety shoes

During dismantling the safety shoes are mandatory again in the exhibit halls on:

- Wednesday 02/07
- Thursday 03/07

Helmets only have to be worn by construction workers



At the entrance of the venue, near to gate A2 you can see an information point where you can buy safety shoes. *It's not possible to rent safety shoes.*

The closest shop where you can buy safety shoes is at Bricorama Châtillon, at 3,4 km from the venue (17 min drive, 45 min on foot)

https://www.bricorama.fr/magasin/chatillon-sous-bagneux/08971?store=08971&utm_source=gmb



Shell scheme stands

- For the exhibitors who ordered a shell scheme booth, their shell schemes will be built-up on Friday, 27 June.
- Their ordered furniture will be delivered to their stands on Saturday, 28 June. Please make sure you ordered furniture through Viparis' Webshop on [Manifestation home](#)
- AV and plants will be delivered on Sunday, 29 June.

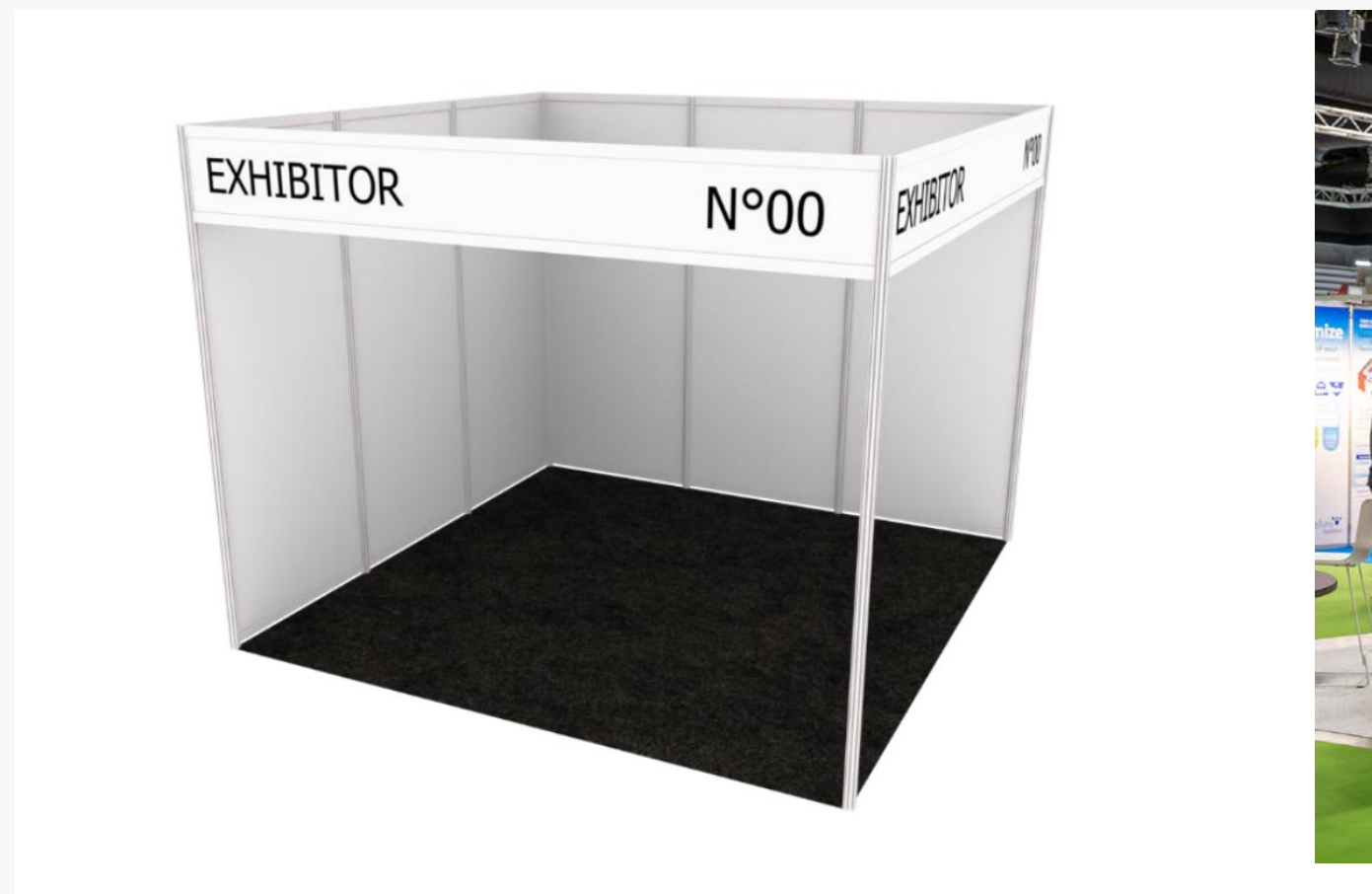



Booth Walkthroughs on Sunday 29 June

Some of the exhibitors are conducting booth walkthroughs and hold team meetings for their staff, once their booth set-up is complete.

- Booth walkthroughs can be held between 17:00 and 20:00 on Sunday, 29 June
- Those already in the exhibit halls before 17:00 on Sunday can stay until 20:00, which is when the opening reception starts at the exhibit hall
- **Only participants who have an orange line on their badge are allowed into the exhibit hall for the booth walkthrough between 17:00 and 20:00**

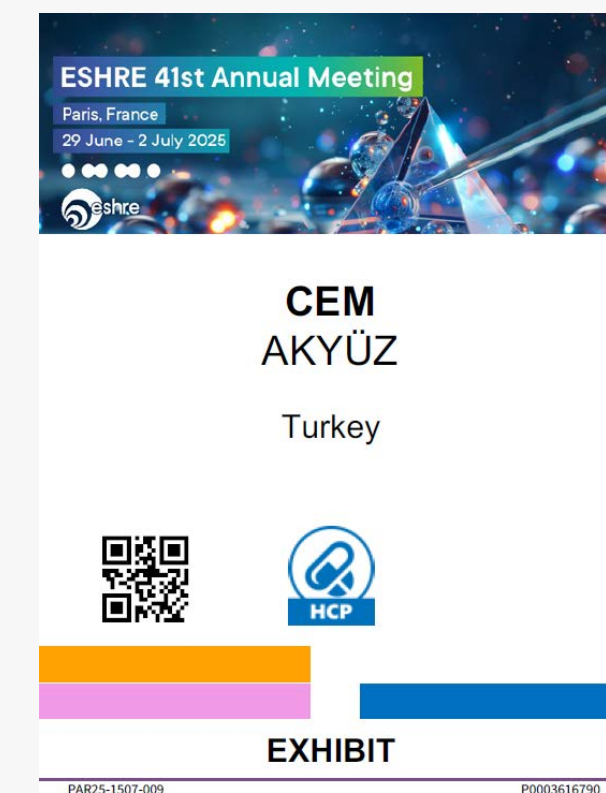



Exhibitors desk

Viparis is the venue's official supplier of booth material for the stand holders (e.g. furniture, cleaning, electricity etc.).

The stand holders can already order booth material in the Viparis' Webshop before the start of the congress on [Manifestation home](#)

Viparis will have an Onsite Exhibitors desk at the exhibit hall.

Opening hours Exhibitors desk

- Thursday, 26 June from 08:00 to 18:00
- Friday 27 June from 07:00 to 20:00
- Saturday 28 June from 07:00 to 20:00
- Sunday 29 June from 07:00 to 17:00
- Monday 30 June from 07:30 to 16:00
- Tuesday 1 July from 08:00 to 12:00

Responsibilities Onsite Exhibitors Desk

- Handle last minute orders of stands
- Answer technical questions stand builders and holders
- Answer questions about access and parking from stand builders and holders



Kristal

Kristal is ESHRE's official freight forwarder
They don't have a booth number this year.
They are located next to the Exhibitor Lounge and cloakroom

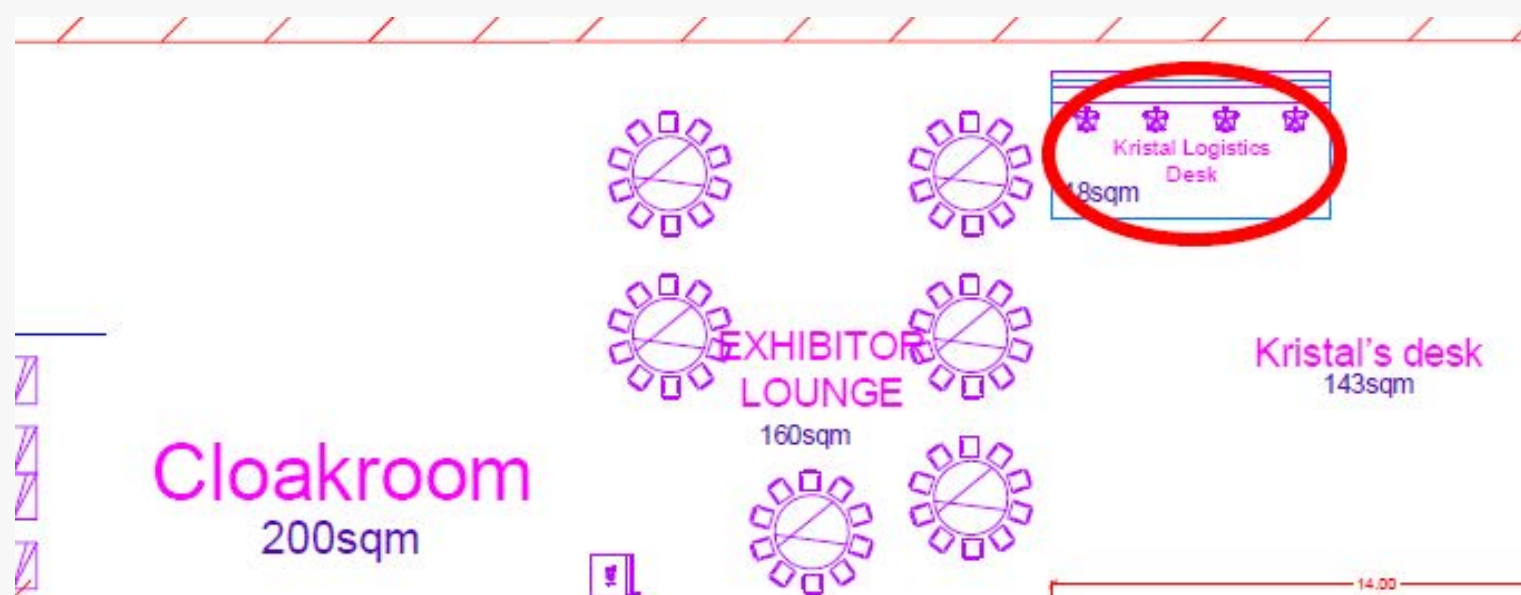

Responsibilities:

- unloading the trucks
- delivering booth materials to some exhibitors' stands
- Store empties and exhibitors' brochures and give-aways during the event

Opening hours Kristal's desk:

- Wednesday 25/06: 17:00-20:00 (early build-up)
- Thursday 26/06: 07:00-19:00
- Friday 27/06: 07:00-19:00
- Saturday 28/06: 07:00-21:00
- Sunday 29/06 : 07:00-17:00
- Monday 30/06: 08:00-17:00
- Tuesday 01/07: 08:00-17:00
- Wednesday 02/07: 08:00-21:00
- Thursday 03/07: 08:00-20:00

You can find information about Kristal on
<https://www.eshre.eu/ESHRE2025/Exhibit-and-Sponsors/Exhibitor-Manual/Freight-forwarding>



Badge scanners / Lead retrievals

- Before the start of the congress exhibitors had the possibility to order badge scanners with COVR
- With these badge scanners the exhibitors can scan the delegates' badges and retrieve their contact details
- Simba from COVR, who will be sitting at the Exhibitors' Desk, will take care of these badge scanners. The exhibitors can only pick up the scanners at Simba's desk and should return all badge scanners to Simba when the congress is finished
- If you haven't ordered a badge scanner yet, then go to <https://www.eshre.eu/ESHRE2025/Exhibit-and-Sponsors/Exhibitor-Manual/Badge-scanners-lead-retrievals> and book before 22 June





Coffee and lunch for exhibitors

Free coffee and lunch

From Monday 30 June till Wednesday 2 July free coffee and lunch will be served in the exhibit hall 7.2. for the delegates and the exhibitors

Exhibitors Lounge – Exhibit hall

During the congress days the stand holders will be able to pick up their lunch in a separate Exhibitors Lounge, located between the cloakroom and Kristal's desk

It will be a grab and go with prepared lunch bags. Only the exhibitors who are wearing a badge with the orange line will have access to the Exhibitor Lounge

There will be a host who will be checking the badges.

Opening hours Exhibitors Lounge

- Monday – Wednesday: Morning break: 08:00 – 10:30
- Monday – Wednesday: Lunch break: 11:00 – 14:00
- Monday – Tuesday: Afternoon Break: 15:00 – 17:30

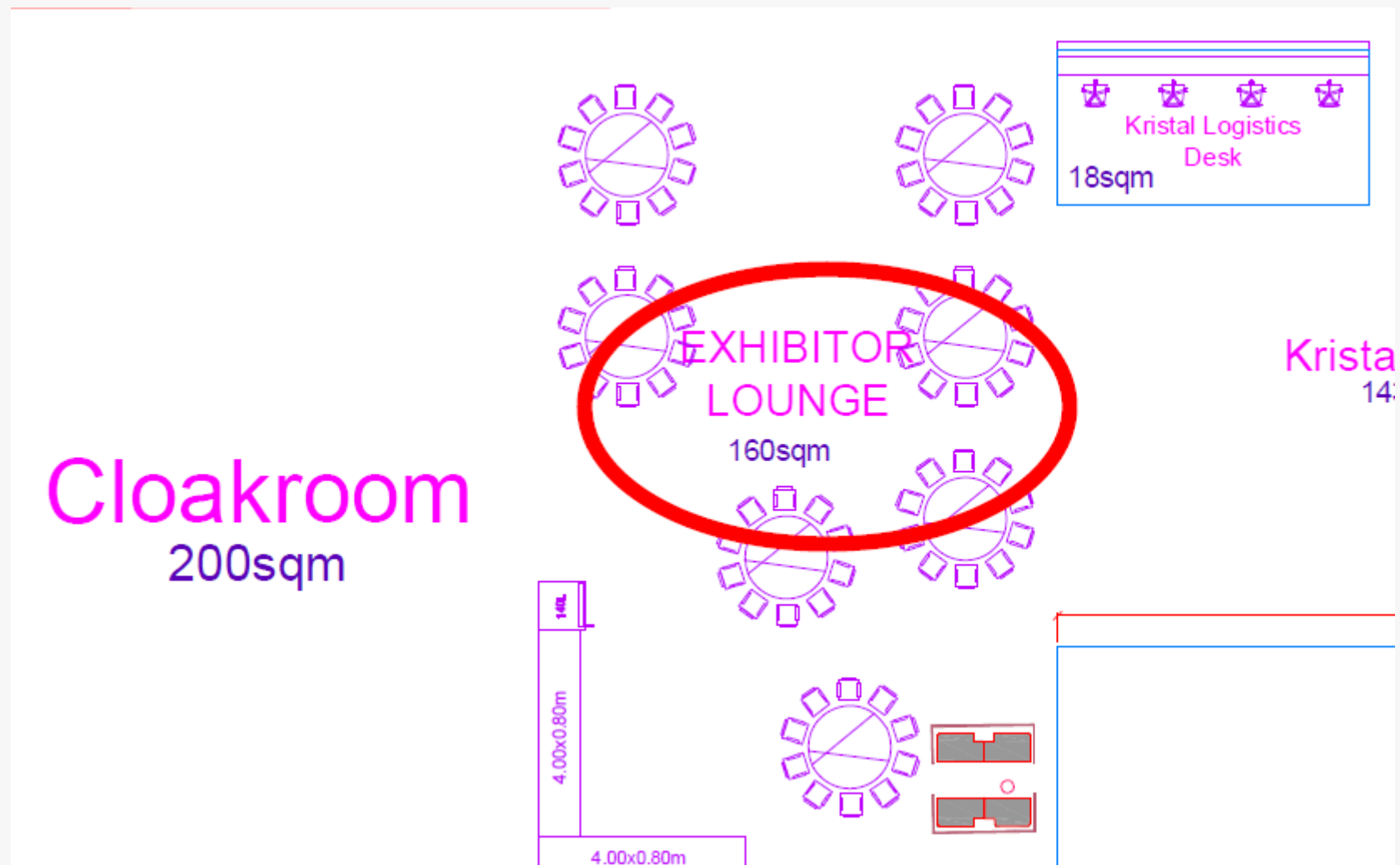



Official Opening & Reception

Opening hours Exhibition

Official Opening Exhibition & Reception

- Sunday, 29 June at 20:00:
the Exhibition will be officially opened in hall 7.2.
- Sunday, 29 June from 20:00 to 22:00:
Welcome Reception with finger food and drinks will be held in hall 7.2.



Opening hours Exhibition for visitors and delegates during the congress

Sunday, 29 June	20:00-22:00
Monday, 30 June	08:30-17:00
Tuesday, 1 July	08:30-17:00
Wednesday, 2 July	08:30-14:00

Official ESHRE breaks

Morning	09:30-10:00
Lunch	13:00-14:00
Afternoon	16:30-17:00

During the congress days exhibitors will have access to the exhibit hall from 07:30 (the exhibit will be open for visitors as of 08:30)



ESHRE 2025

General Briefing



Venue

Paris Expo Porte de Versailles

1 Place de la Porte de Versailles

75015 Paris

France

From Paris Gare du Nord: take metro line 4 (in the direction of Bagneux-Lucie Aubrac) and get off at Montparnasse-Bienvenue. Then take metro line 12 (in the direction of Mairie d'Issy) and get off at Porte de Versailles.

Metrostation "Porte de Versailles" is located in front of Paris Expo Porte de Versailles

See also <https://www.viparis.com/nos-lieux/paris-expo-porte-de-versailles/acces> for more info on "how to get there".

Virtual tour <https://www.viparis.com/nos-lieux/paris-expo-porte-de-versailles/espaces>





A2 = entrance gate

Pavilion 7





Venue - overview

LEVEL 7.2

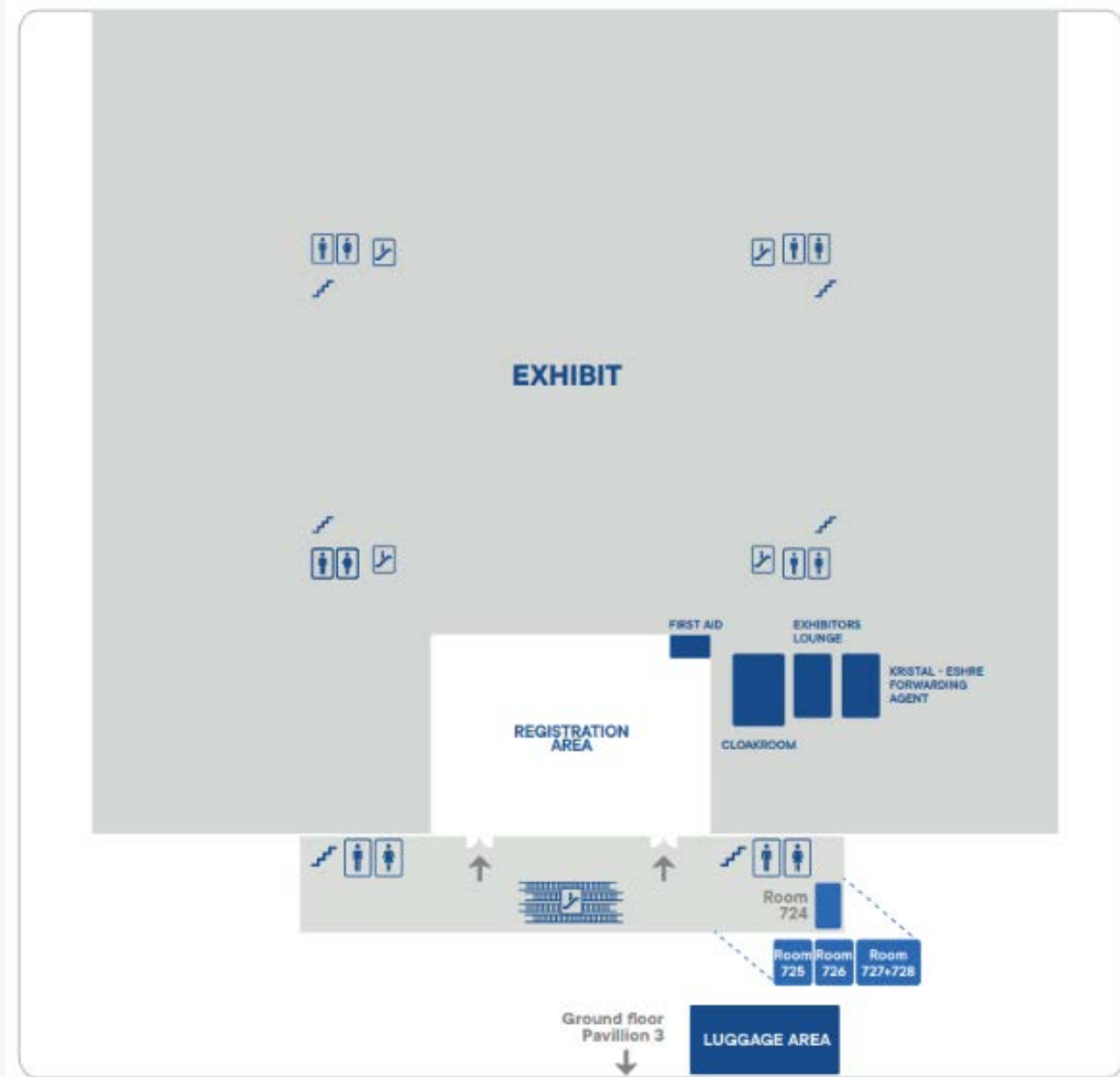

7.2 (first floor)

- Exhibit
- Registration

LEVEL 7.3

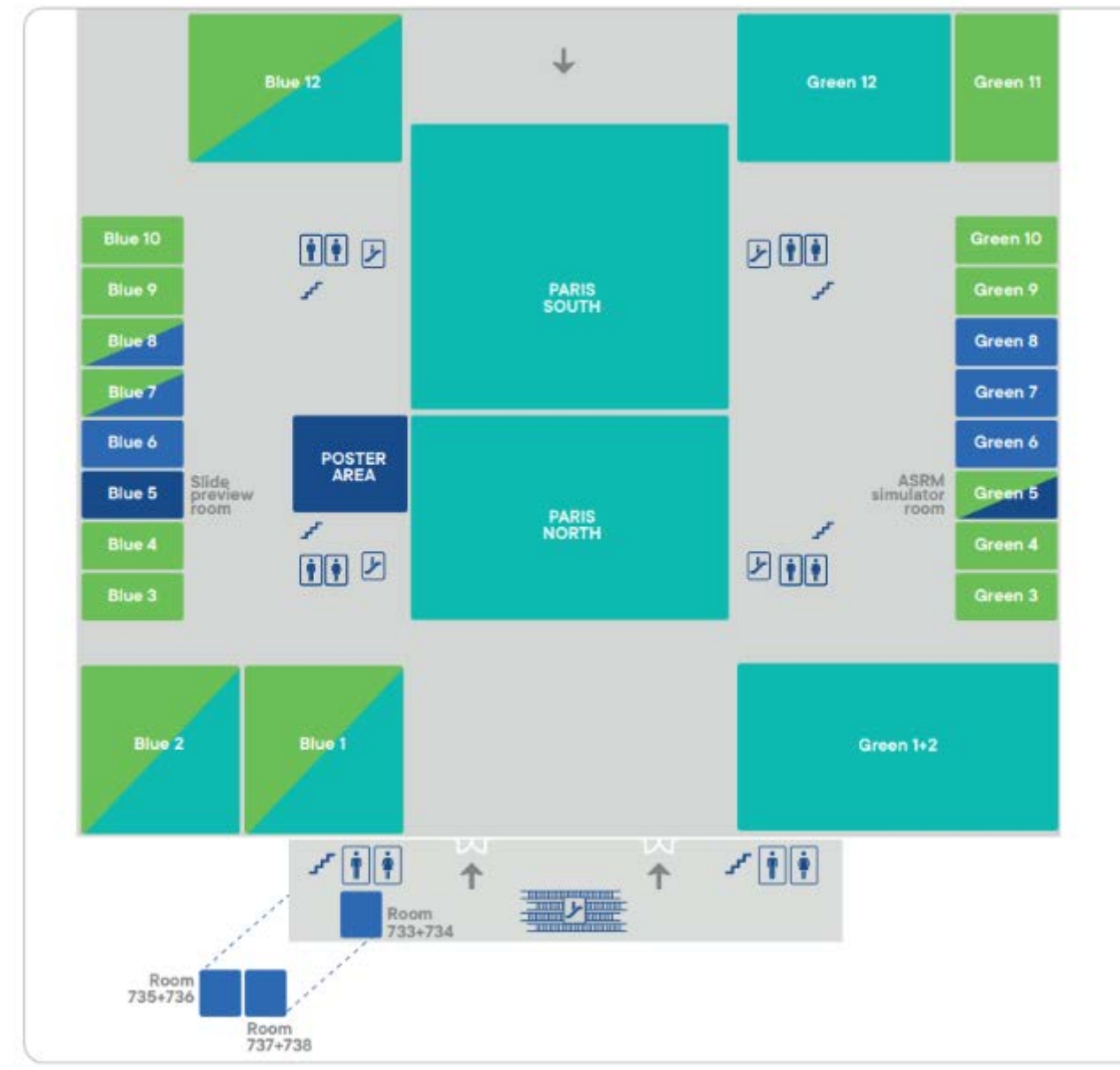

7.3 (second floor)

- Session rooms

LEVEL 7.4

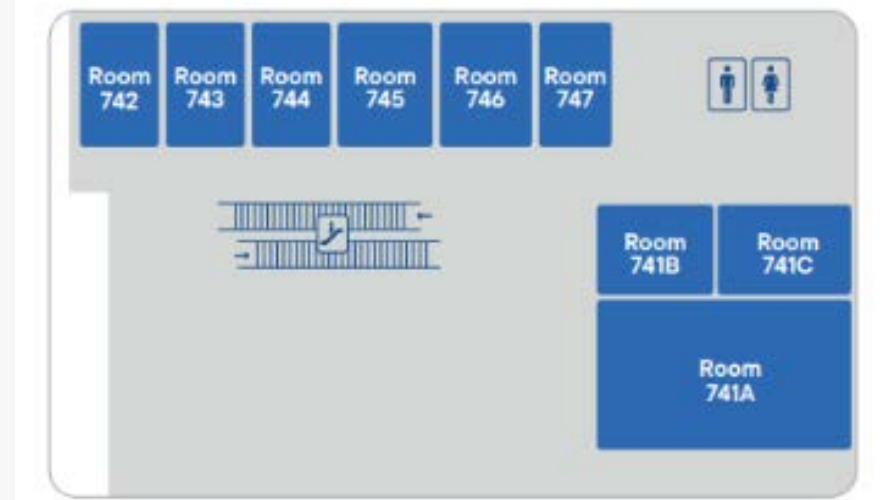

7.4 (third floor)

- Meeting rooms



Venue

First floor (7.2)

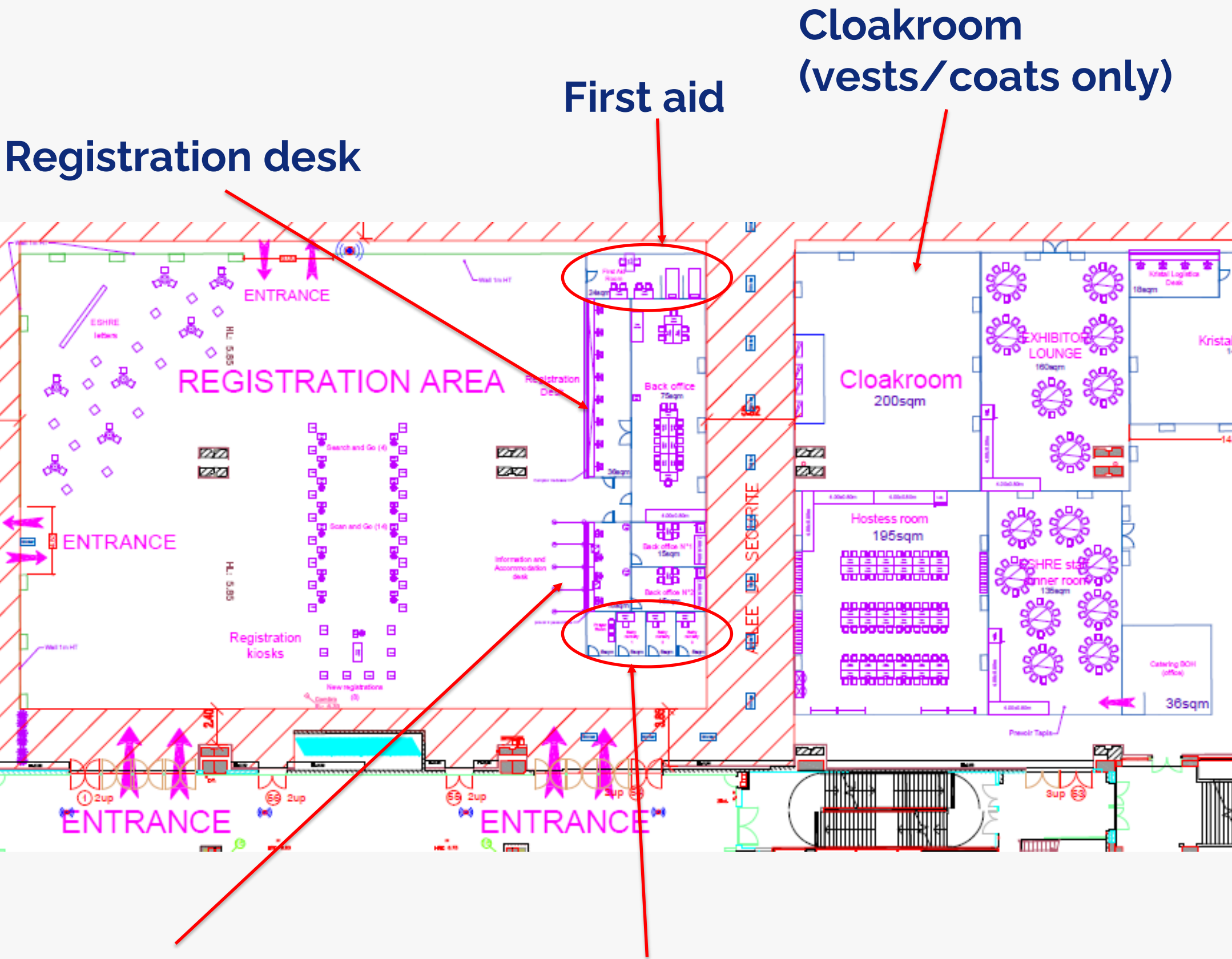

Accommodation
and information
desk

Baby care rooms and
prayer room





Registration area

Opening hours registration, app support, accommodation and information desks

- Saturday, 28 June from 13:00 to 20:00
- Sunday, 29 June from 07:30 to 20:00.
- Monday, 30 June from 07:30 to 18:00
- Tuesday, 1 July from 08:00 to 18:00
- Wednesday, 2 July from 08:00 to 15:00



Access for participants

CONGRESS DAYS

All badges have one or more coloured blocks on the bottom of the front side.

There are five colours:

- Yellow = access to a Precongress Course on Sunday
- Blue = access to the Scientific programme on Monday, Tuesday and Wednesday
- Pink = access to exhibit during opening hours
- Orange = access to exhibit outside opening hours
- Green = access to a committee/company meeting outside official opening hours or if not registered for ESHRE 2025



Badge examples

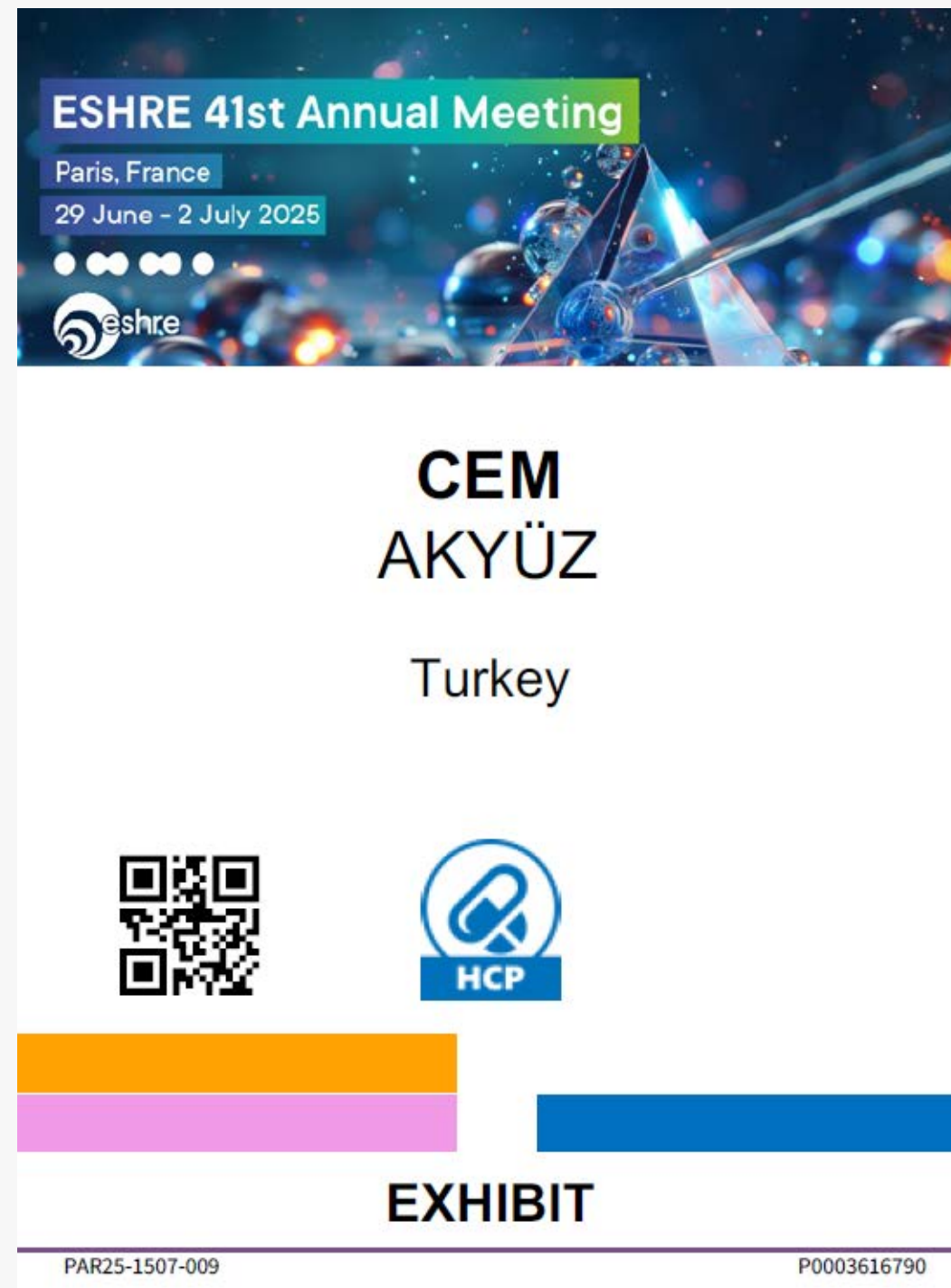

Exhibitor attending
main programme



Exhibitor

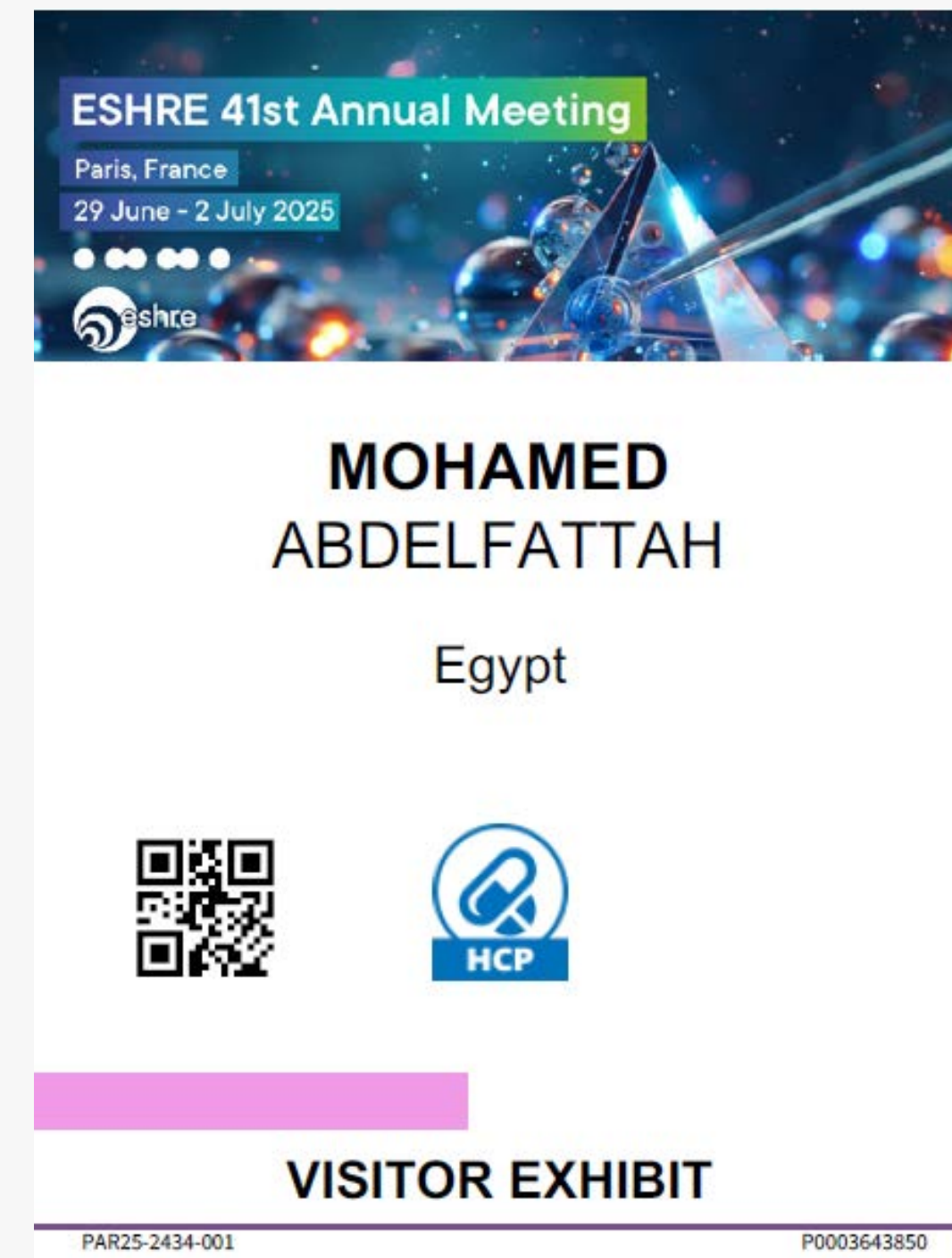

Visitor exhibit





Badge examples



Main programme

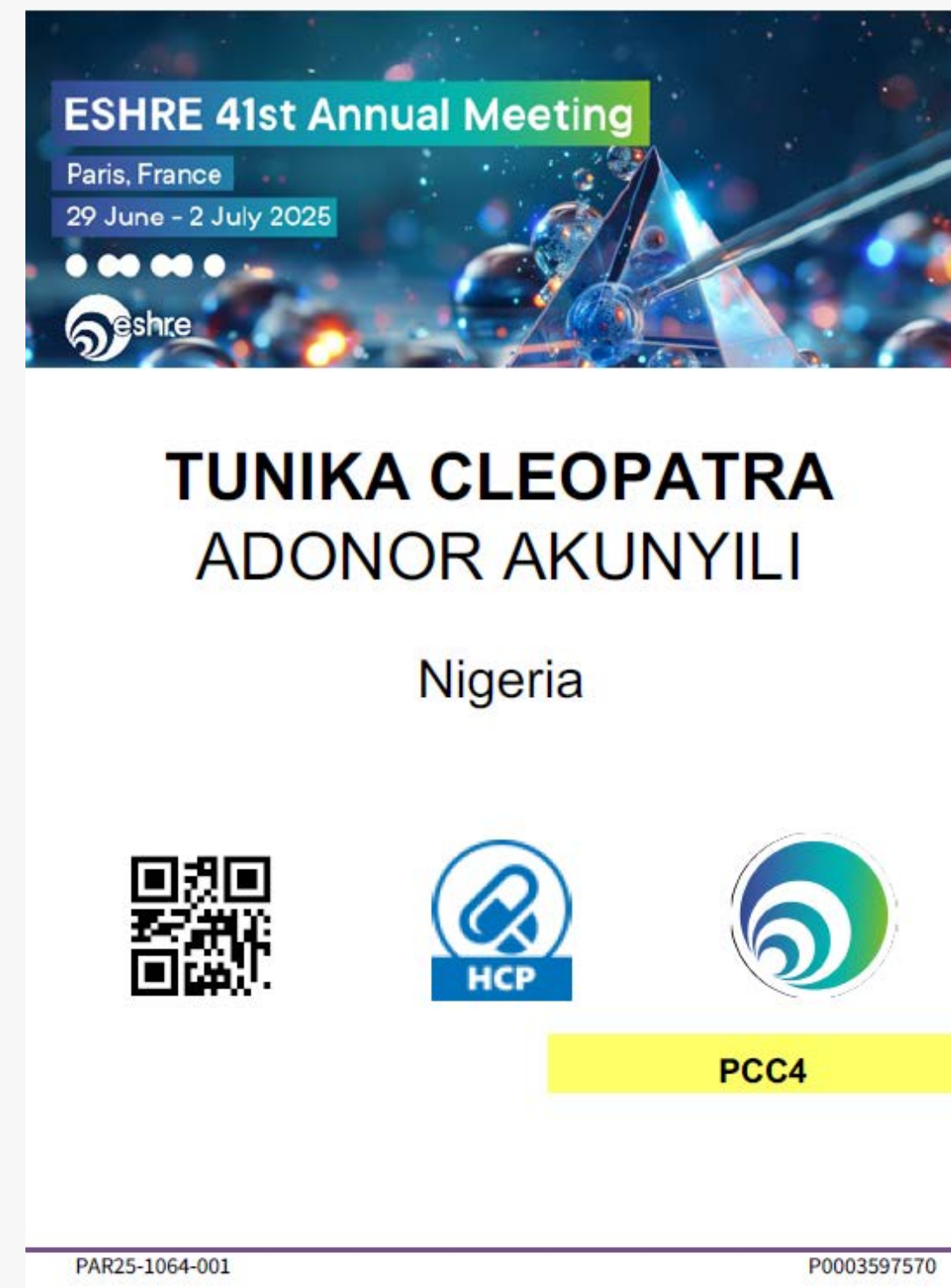

Precongress course only





Scientific Programme

Details → <https://www.eshre.eu/ESHRE2025/Programme/ESHRE-2025-Searchable-scientific-programme#/cmcore>

Sunday, 29 June

✓ **14 Precongress Courses**

Monday, 30 June → Wednesday, 2 July

✓ **Main programme including invited sessions, selected oral communications, poster discussion sessions**

✓ **Poster viewing**

ESHRE 2025 Searchable scientific programme

⋮ CHANGE VIEW ...

Session schedule

🔍

FILTERS

🗒

Sun29

Mon30

Tue1

Wed2

	Paris South	Paris North	Green 1+2	Blue 12	Green 12	Blue 2	Blue 1	Green 5	Exhibit hall
08:00									
	Session 01: Keynote session								
09:00								Practicing embryo transfer techniques using a virtual reality-based simulator	Coffee break
10:00	Session 02: Non invasive prediction of aneuploidy - are we there yet?	Session 03: Novels ways to improve fertility outcomes	Session 04: Male factors for ART success and failure	Session 05: RCTs and basic research in implantation and early pregnancy	Session 06: Reproductive outcomes after fertility preservation	Session 07: The hidden impact of environment and chemicals on fertility	Session 08: Poster discussion session - Embryology		
11:00									
		Session 09: Debate: Should we transfer embryos derived from OPN-1PN-3PN?	Session 10: Data reporting session	Session 11: ASRM Exchange session: Challenging cases: clinical and laboratory perspectives	Session 12: Managing weight and nurturing life	Session 13: IRHEC session: International Reproductive Health Education Collaboration (IRHEC) - An update	Session 14: Poster discussion session - Stem cells		
12:00									
13:00									Lunch break



ESHRE 2025

Opening Ceremony & Welcome Reception

When: Sunday 29 June, from 19:00 to 20:00 (ceremony) and from 20:00 to 22:00 (reception)

Where: Paris South (7.3; ceremony) and exhibit (7.2; reception)

Who: Only registered participants. Badges will be scanned at the entrance of the Paris South. If they are not registered, the hostesses will send them to the self-registration kiosk to buy a ticket. The ones with a free exhibitor badge, have a free ticket to the opening ceremony. The ones with a payable exhibitor badge, have to pay 2,50€ for the opening ceremony.

What: Welcome speeches, celebration of the Honorary Members and a dance act by NeoDance Academy. Reception at the exhibit with finger food and drinks.

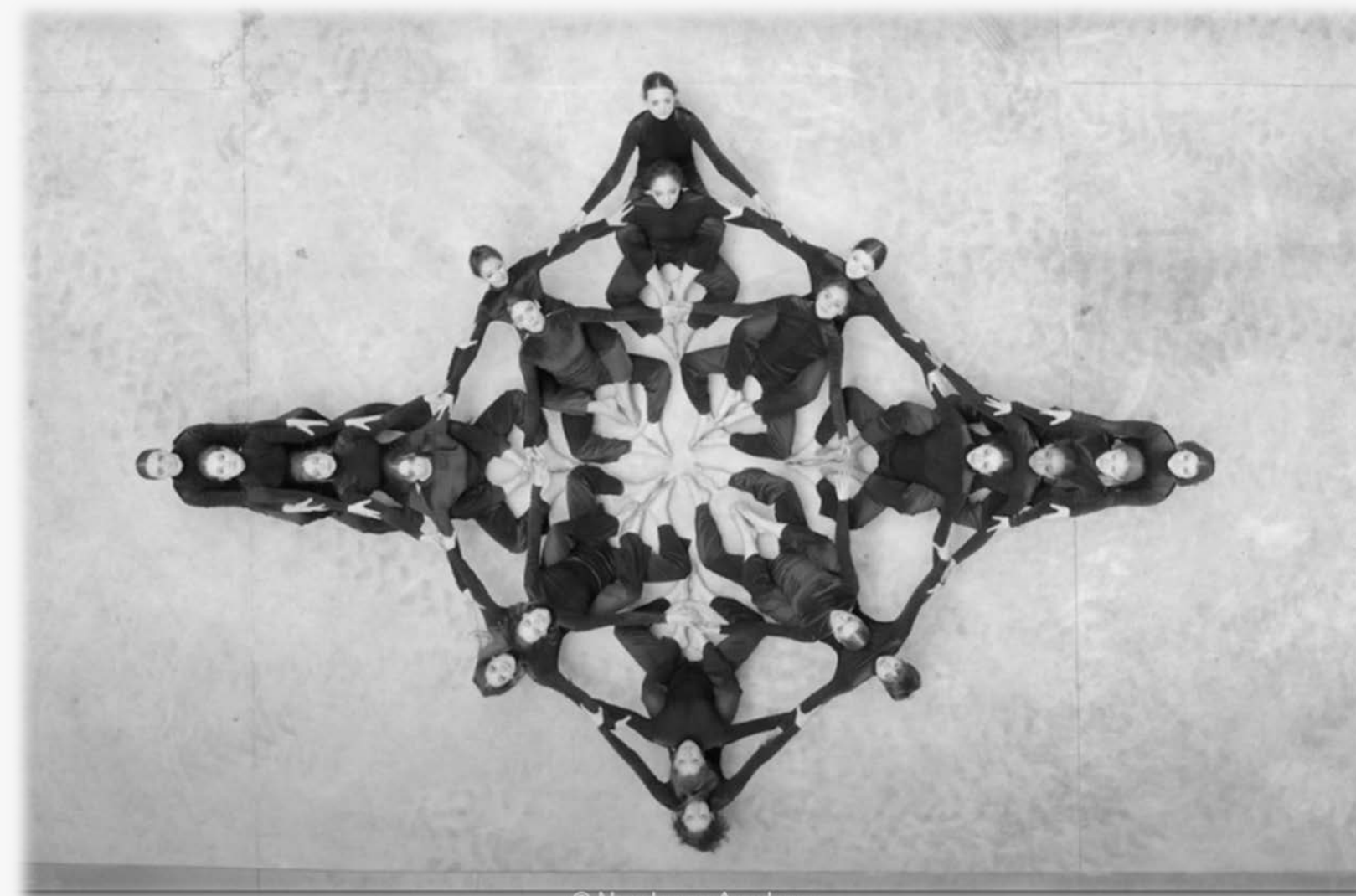

© Neodance Academy



ESHRE 2025

Closing Reception

When: Wednesday 2 July, from 15:30 to 16:30

Where: Blue 2

Who: ESHRE 2025 participants (no separate registration necessary)

What: Reception with finger food and drinks.





Useful stuff to remember...

- ✓ Travel from Paris Gare du Nord to the Paris Expo Porte de Versailles
➔ metro line 4 (in the direction of Bagneux-Lucie Aubrac) and get off at Montparnasse-Bienvenue. Then take metro line 12 (in the direction of Mairie d'Issy) and get off at Porte de Versailles.

- ✓ “passerelle” (located next to Pavilion 6),

- ✓ opening times:

- Saturday: 7:00-20:30
- Sunday: 06:00-23:00
- Monday: 06:00-20:00
- Tuesday: 06:00-20:00
- Wednesday: 06:00-20:00

Via the street
Gate A2

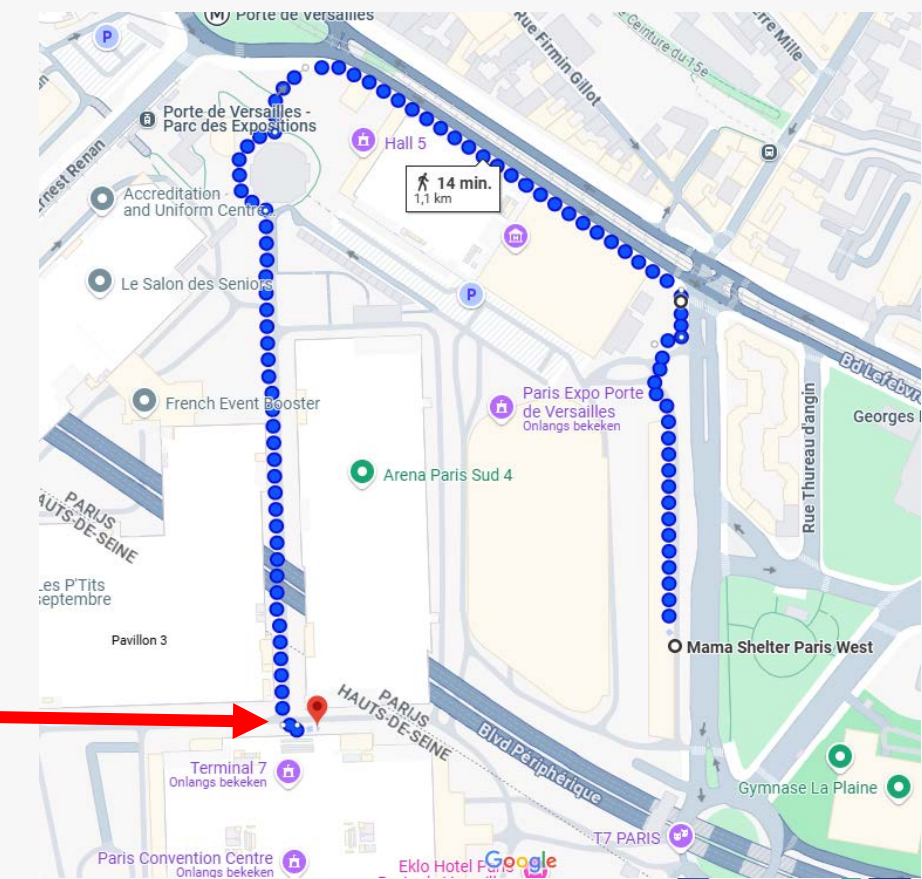
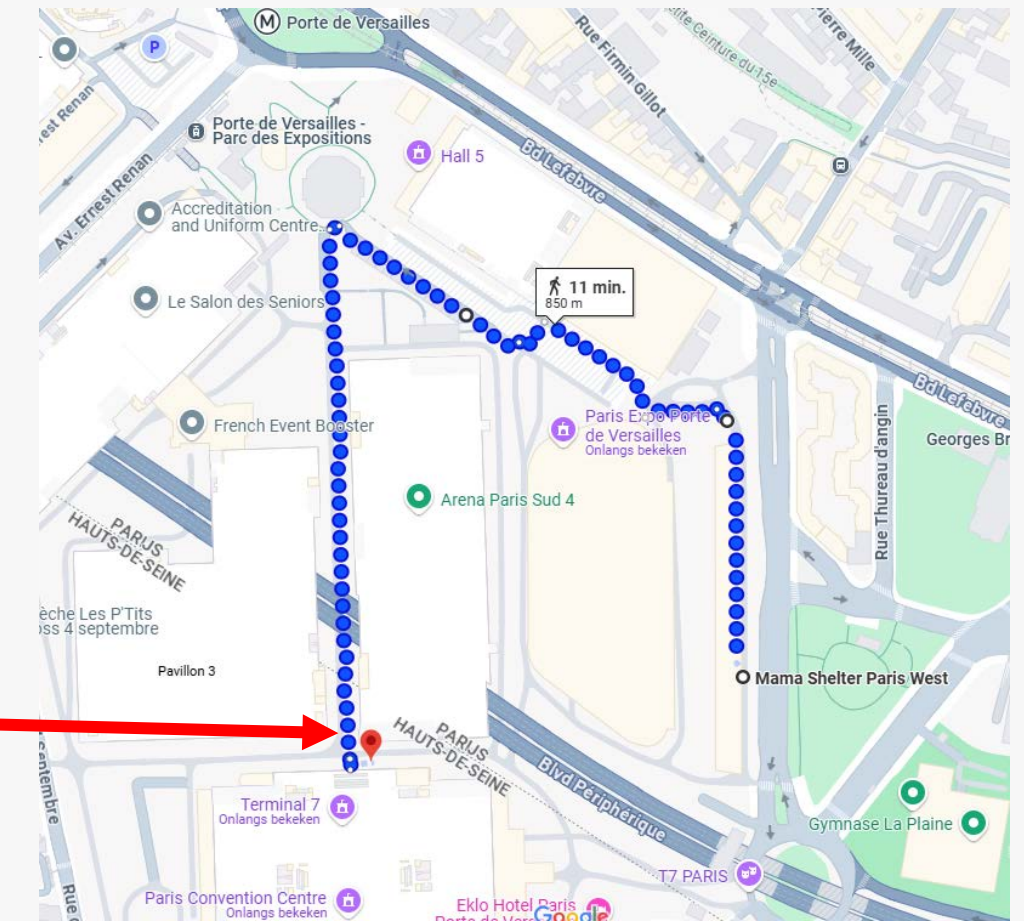



Useful stuff to remember...

- ✓ WIFI: SSID: ESHRE2025
Password: EshreParis2025
- ✓ Lost and found → VIP registration desk
- ✓ Cloakroom (inside) and Luggage room (outside) → service for participants is free of charge
- ✓ Children (0-18 years) are not allowed beyond registration area
- ✓ No public transportation tickets this year
- ✓ ATM machine → outside Pavilion 3



See you soon!

www.eshre.eu

European Society of Human Reproduction and Embryology